

Band	Link	Output Power <sup>1</sup>	ERP <sup>2</sup>
1	Downlink	20 (dBm)	25.1 (dBm)
	Uplink	22 (dBm)	27.1 (dBm)
3	Downlink	20 (dBm)	25.1 (dBm)
	Uplink	22 (dBm)	27.1 (dBm)
5	Downlink	20 (dBm)	25.4 (dBm)
	Uplink	20 (dBm)	25.4 (dBm)
7	Downlink	20 (dBm)	25.4 (dBm)
	Uplink	22 (dBm)	27.4 (dBm)
8	Downlink	20 (dBm)	25.1 (dBm)
	Uplink	20 (dBm)	25.1 (dBm)
20	Downlink	20 (dBm)	25.1 (dBm)
	Uplink	20 (dBm)	25.1 (dBm)
28L	Downlink	20 (dBm)	25.1 (dBm)
	Uplink	20 (dBm)	25.1 (dBm)
28U	Downlink	20 (dBm)	25.1 (dBm)
	Uplink	20 (dBm)	25.1 (dBm)
40	Downlink	20 (dBm)	25.4 (dBm)
	Uplink	22 (dBm)	25.4 (dBm)

Model Number	Bands Supported
G41-JE	1, 3, 5, 7, 8, 28L, 40
G41-9E	1, 3, 7, 8, 20
G41-QE	1, 3, 5, 7, 28L
G41-NE	1, 3, 5, 7, 28U, 40

## Mounting Instructions

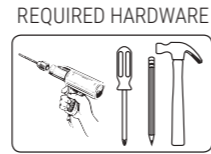
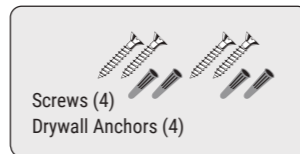

NOTE: This package comes equipped with screws and drywall anchors for mounting in standard drywall. Before you install the mounts, make sure there are no wires or other objects, or metal plates, behind the drywall that may interfere with the inserts, screws, mount, or mounted units.

**1** Determine Cel-Fi GO G41 location. (Refer to Installation section). Determine mounting hole locations.



**3** Install unit.

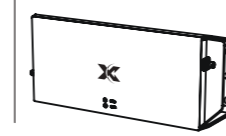

**2** In each marked spot, use a 3/16" drill bit to drill guide holes for the anchors. Install anchors (Drywall).

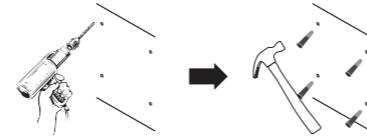

**4** Attach the donor and server antennas.

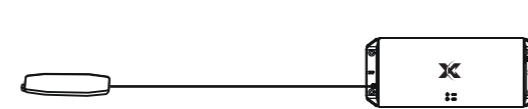

## Cel-Fi™ GO G41 Quick Start Guide

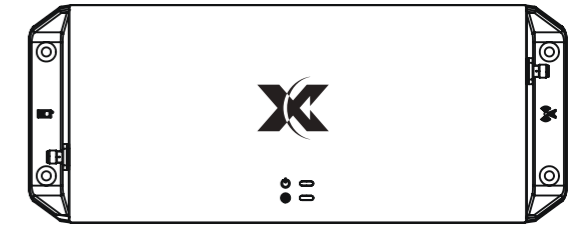

### MODEL NUMBERS:

G41-JE-001	G41-9E-001	G41-QE-001	G41-NE-001
G41-JE-002	G41-9E-002	G41-QE-002	G41-NE-002
G41-JE-003	G41-9E-003	G41-QE-003	G41-NE-003
KG41-JE-111	KG41-9E-111	KG41-QE-111	KG41-NE-111
KG41-JE-222	KG41-9E-222	KG41-QE-222	KG41-NE-222
KG41-JE-333	KG41-9E-333	KG41-QE-333	KG41-NE-333

## Antenna Options



Review the latest authorized antennas at:  
[www.cel-fi.com/antennas](http://www.cel-fi.com/antennas)

Band	Link	Output Power <sup>1</sup>	ERP <sup>2</sup>
1	Downlink	20 (dBm)	25.1 (dBm)
	Uplink	22 (dBm)	27.1 (dBm)
3	Downlink	20 (dBm)	25.1 (dBm)
	Uplink	22 (dBm)	27.1 (dBm)
5	Downlink	20 (dBm)	25.4 (dBm)
	Uplink	20 (dBm)	25.4 (dBm)
7	Downlink	20 (dBm)	25.4 (dBm)
	Uplink	22 (dBm)	27.4 (dBm)
8	Downlink	20 (dBm)	25.1 (dBm)
	Uplink	20 (dBm)	25.1 (dBm)
20	Downlink	20 (dBm)	25.1 (dBm)
	Uplink	20 (dBm)	25.1 (dBm)
28L	Downlink	20 (dBm)	25.1 (dBm)
	Uplink	20 (dBm)	25.1 (dBm)
28U	Downlink	20 (dBm)	25.1 (dBm)
	Uplink	20 (dBm)	25.1 (dBm)
40	Downlink	20 (dBm)	25.4 (dBm)
	Uplink	22 (dBm)	25.4 (dBm)

Model Number	Bands Supported
G41-JE	1, 3, 5, 7, 8, 28L, 40
G41-9E	1, 3, 7, 8, 20
G41-QE	1, 3, 5, 7, 28L
G41-NE	1, 3, 5, 7, 28U, 40

## Mounting Instructions

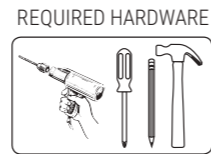
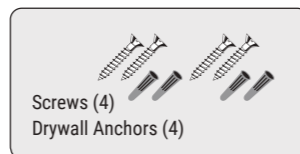

NOTE: This package comes equipped with screws and drywall anchors for mounting in standard drywall. Before you install the mounts, make sure there are no wires or other objects, or metal plates, behind the drywall that may interfere with the inserts, screws, mount, or mounted units.

**1** Determine Cel-Fi GO G41 location. (Refer to Installation section). Determine mounting hole locations.



**3** Install unit.

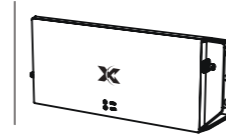

**2** In each marked spot, use a 3/16" drill bit to drill guide holes for the anchors. Install anchors (Drywall).

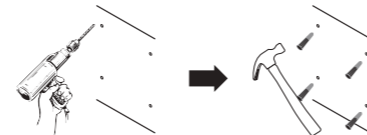

**4** Attach the donor and server antennas.



## Cel-Fi™ GO G41 Quick Start Guide



### MODEL NUMBERS:

G41-JE-001	G41-9E-001	G41-QE-001	G41-NE-001
G41-JE-002	G41-9E-002	G41-QE-002	G41-NE-002
G41-JE-003	G41-9E-003	G41-QE-003	G41-NE-003
KG41-JE-111	KG41-9E-111	KG41-QE-111	KG41-NE-111
KG41-JE-222	KG41-9E-222	KG41-QE-222	KG41-NE-222
KG41-JE-333	KG41-9E-333	KG41-QE-333	KG41-NE-333

## Antenna Options



Review the latest authorized antennas at:  
[www.cel-fi.com/antennas](http://www.cel-fi.com/antennas)

# Quick Installation

IMPORTANT: Your **Cel-Fi GO G41** is electronic equipment. The **Cel-Fi GO G41** must be kept indoors and in a dry, cool, well ventilated area.

## 1 Define Coverage Problem

Determine where coverage is needed. This is where the **server antenna** should be placed.

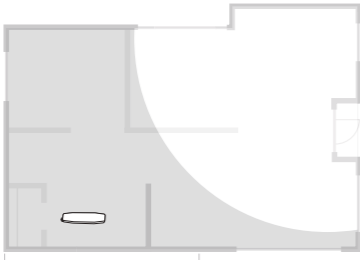

## 2 Place Main Unit

Place the **main unit** as far away from the **server antenna** as the cable will allow, close to a window where there is coverage.

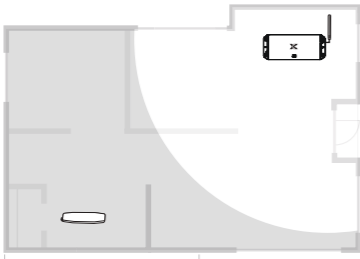

Ideally it should be placed with at least one wall between the donor and server antennas. If the patch antenna cable is too short, it may be extended.

# Quick Installation

IMPORTANT: Your **Cel-Fi GO G41** is electronic equipment. The **Cel-Fi GO G41** must be kept indoors and in a dry, cool, well ventilated area.

## 1 Define Coverage Problem

Determine where coverage is needed. This is where the **server antenna** should be placed.

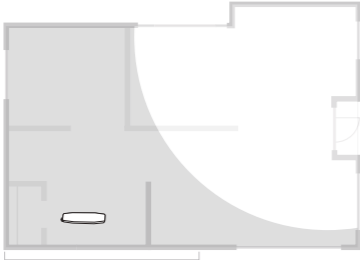

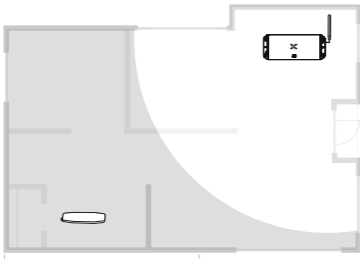

## 2 Place Main Unit

Place the **main unit** as far away from the **server antenna** as the cable will allow, close to a window where there is coverage.

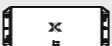

Ideally it should be placed with at least one wall between the donor and server antennas. If the patch antenna cable is too short, it may be extended.

**Included In the Box**  
*Other variations of the product package may include additional antennas or components.*

 Main Unit
  AC Adapter

## 3 Attach Server and Donor Antennas

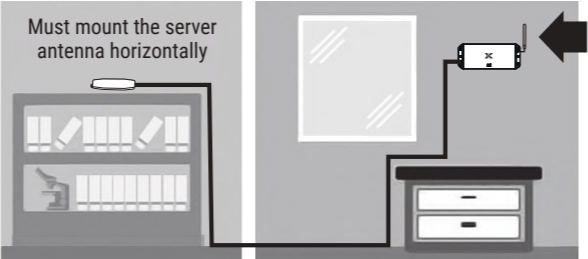

Attach the **donor antenna** and **server antenna** to the main unit.



Keep donor and server antenna separated/isolated from each other as far away as possible for best performance.

## 4 Plug In Cel-Fi GO G41

Plug-in the unit to power. The LED on the front will blink during setup.

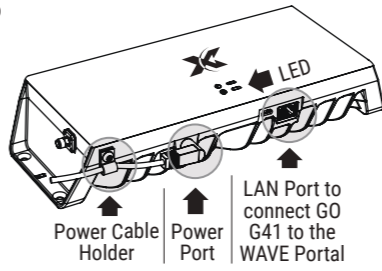

## 5 Cel-Fi WAVE App

The **Cel-Fi WAVE** app can be used to optimize the Cel-Fi GO G41 performance.

The antenna locations can be adjusted or relocated and system performance quickly assessed via the **Cel-Fi WAVE** app.

**Bluetooth** WAVE app smart phone connects to the GO G41 via **Bluetooth LE**:

**Frequency:** 2402-2480 MHz  
**Power:** 0 dBm

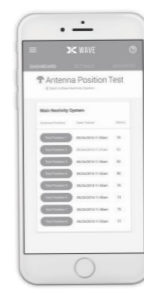

# Advanced Install

For best results, separate the donor and server antenna(s) as much as possible. Antenna separation (*isolation*) can be achieved with either physical distance or by having materials (like a wall) between the antennas.

Make sure any cables, splitters, and antennas used in the system are properly matched. (*Cel-Fi GO G41 is rated for 50Ω*)

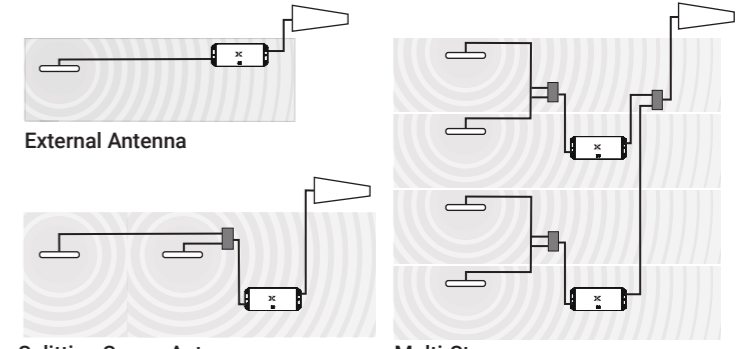

- Recommend**
- > 20dB port-to-port isolation for any splitter
  - External directional antenna #A62-V44-200 will provide best overall system performance
  - Wideband panel antenna #A52-V32-100 may be used as an effective indoor donor antenna

- Downlink power should be:**
- > 0dBm to use a two-way splitter
  - > 3dBm to use a four-way splitter

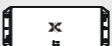

**Cel-Fi Safe** Copyright © 2021 by Nextivity, Inc, U.S. Patents pending. All rights reserved. The Nextivity and Cel-Fi logos are registered trademarks of Nextivity Inc. All other trademarks or registered trademarks listed belong to their respective owners. Designed by Nextivity Inc in California.

**Included In the Box**  
*Other variations of the product package may include additional antennas or components.*

 Main Unit
  AC Adapter

## 3 Attach Server and Donor Antennas

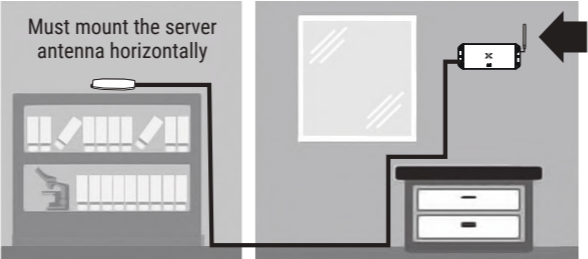

Attach the **donor antenna** and **server antenna** to the main unit.



Keep donor and server antenna separated/isolated from each other as far away as possible for best performance.

## 4 Plug In Cel-Fi GO G41

Plug-in the unit to power. The LED on the front will blink during setup.

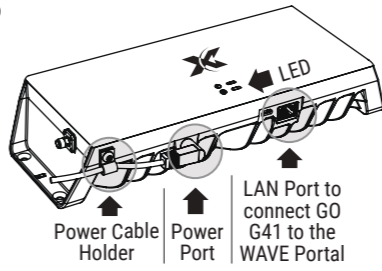

## 5 Cel-Fi WAVE App

The **Cel-Fi WAVE** app can be used to optimize the Cel-Fi GO G41 performance.

The antenna locations can be adjusted or relocated and system performance quickly assessed via the **Cel-Fi WAVE** app.

**Bluetooth** WAVE app smart phone connects to the GO G41 via **Bluetooth LE**:

**Frequency:** 2402-2480 MHz  
**Power:** 0 dBm

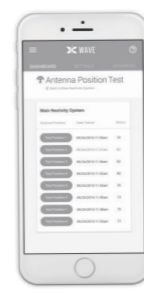

# Advanced Install

For best results, separate the donor and server antenna(s) as much as possible. Antenna separation (*isolation*) can be achieved with either physical distance or by having materials (like a wall) between the antennas.

Make sure any cables, splitters, and antennas used in the system are properly matched. (*Cel-Fi GO G41 is rated for 50Ω*)

- Recommend**
- > 20dB port-to-port isolation for any splitter
  - External directional antenna #A62-V44-200 will provide best overall system performance
  - Wideband panel antenna #A52-V32-100 may be used as an effective indoor donor antenna

- Downlink power should be:**
- > 0dBm to use a two-way splitter
  - > 3dBm to use a four-way splitter

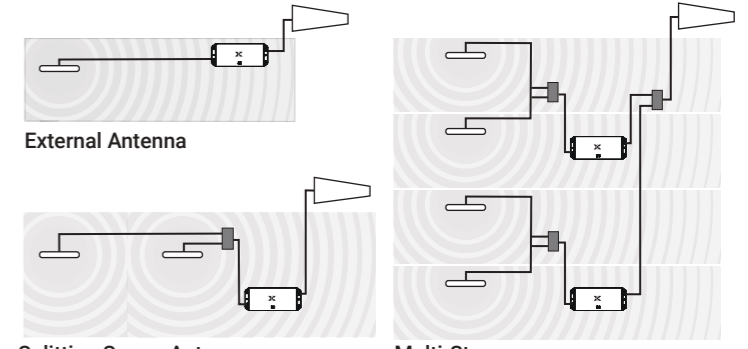

**Cel-Fi Safe** Copyright © 2021 by Nextivity, Inc, U.S. Patents pending. All rights reserved. The Nextivity and Cel-Fi logos are registered trademarks of Nextivity Inc. All other trademarks or registered trademarks listed belong to their respective owners. Designed by Nextivity Inc in California.